

BURNER KING

TOOLS REQUIRED

Power driver POSI-DRIV screwdriver & 6mm drill bit, 7mm & 10mm spanner, 2.5mm allen key

FOR YOUR OWN SAFETY:

- DO NOT place this outdoor stove under trees or near shrubs.
- DO NOT place this outdoor stove inside a structure or shelter under any circumstances.
- DO NOT use this outdoor stove directly onto decking.

- YOU MUST have a concrete or slab base underneath.
- DO NOT touch the stove when in use other than the handle as the external materials of this stove get very hot.
- DO NOT leave the stove unsupervised under any circumstances.
- DO NOT allow children or unsuitable people to use this stove.

**BURN WOOD ONLY - Do not use petrol or other accelerants.
DO NOT burn coal.**

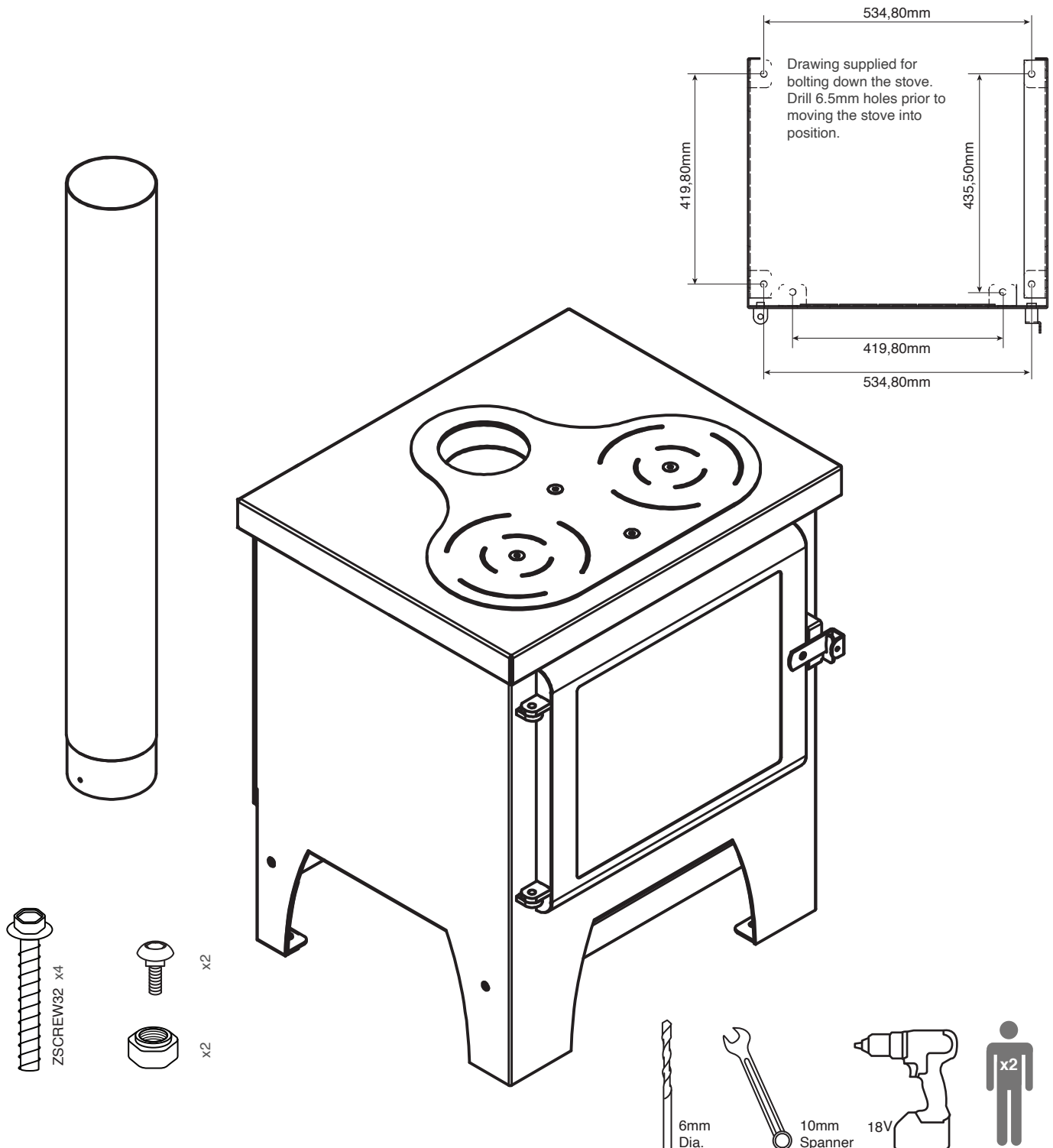

- 1** Drop flue into the stove and screw on the inside using 2x M4 nut & 2x screw

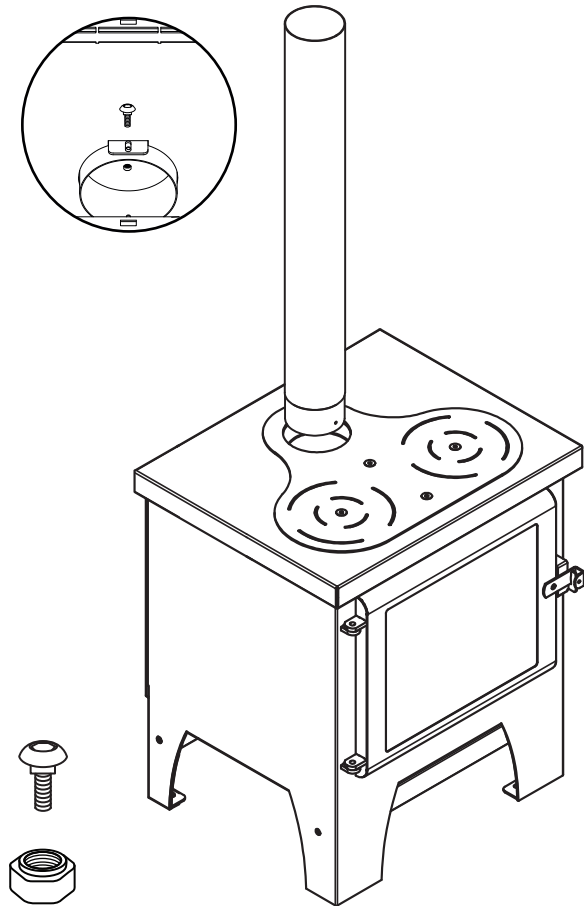

- 2** Drill holes in the floor using hole centre diagram (see pg1). Position your stove & bolt to floor.

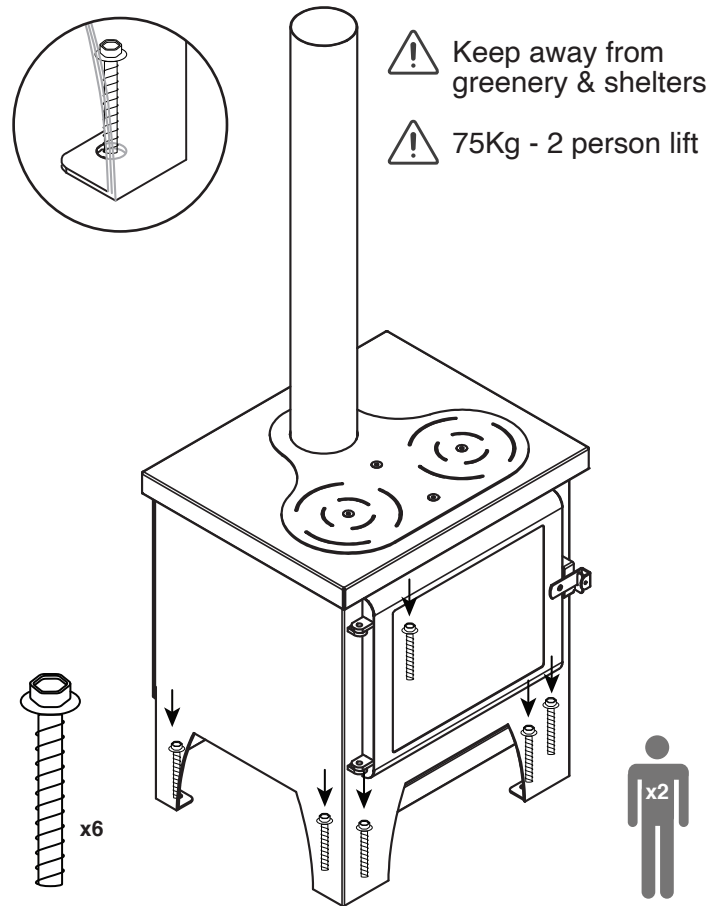

How to clean your stove

Removing Burnt Debris

- 1** Allow to completely cool first before touching the stove
- 2** Remove both grates
- 3** Using a dustpan & brush or suitable Hoover, sweep up the debris and dispose of responsibly.
- 4** Replace both grates

Removing Cooking Marks

- 1** Allow to completely cool first before touching the stove
- 2** If required, use a damp cloth to remove any cooking marks

Discoloration of the paintwork over time is normal

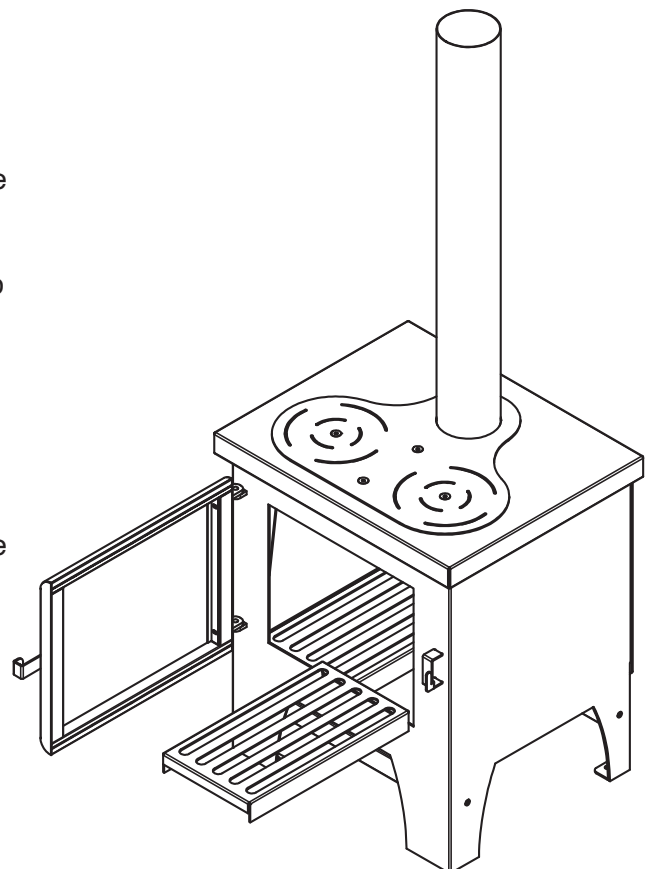

Safety Notice

Disclaimers

DO NOT place this outdoor stove under trees or near shrubs.

DO NOT place this outdoor stove inside a structure or shelter under any circumstances.

DO NOT use this outdoor stove directly onto decking – YOU MUST have a concrete or slab base underneath.

DO NOT touch the stove when in use other than the handle as the external materials of this stove get very hot.

DO NOT leave the stove unsupervised under any circumstances.

DO NOT allow children or unsuitable people to use this stove.

BURN SUITABLE WOOD AND CHIMINEA LOGS ONLY - Do not use petrol, coal, or accelerants.

THIS PRODUCT IS NOT A GARDEN INCINERATOR

BEFORE USING THE WOOD BURNER

On 1st ever use: light a small fire, burn for 30 minutes and allow the burner to cool, repeat for a 2nd time before full use. This will allow the burner to naturally expand ready for full use.

Ensure a minimum gap of 1.5 meters between the stove and any other materials.

Please note:

If the log store is overfilled, or the fuel tray is over-fuelled, excessive heat build-up can occur.

A cover should be used for short-term usage (once the product has cooled), it should be stored in a cool dry place for long-term storage.